

REVISION	DATE	DESCRIPTION

**EXISTING WATER SYSTEM
HIGHFILL PUBLIC WATER SYSTEM
BENTON COUNTY, ARKANSAS**

ENGINEERING SERVICES
INCORPORATED
1207 SOUTH OLD MISSOURI RD.
SPRINGDALE, ARKANSAS 72764

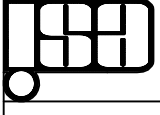

LEGEND

STATE HIGHWAY	EXISTING 36" WATER MAIN
PAVED CITY STREET	EXISTING 18" WATER MAIN
UNPAVED CITY STREET	EXISTING 12" WATER MAIN
PAVED COUNTY ROAD	EXISTING 8" WATER MAIN
GRAVEL COUNTY ROAD	EXISTING 6" WATER MAIN
UNIMPROVED COUNTY ROAD	EXISTING 4" WATER MAIN
TOWNSHIP AND RANGE LINES	EXISTING 3" WATER MAIN
STATE HIGHWAY	EXISTING 2" WATER MAIN
COUNTY ROAD	AIR RELEASE VALVE
CITY	3-WAY FIRE HYDRANT
	2-WAY FIRE HYDRANT
	GATE VALVE
	BLOWOFF VALVE
	MASTER METER
	USER LOCATION
	GATE VALVE AND LEAK DETECTION METER
	BOOSTER PUMP STATION
	SERVICE AREA BOUNDARY

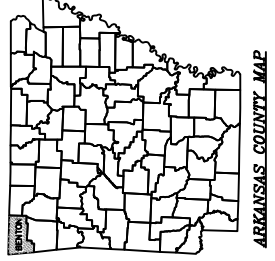
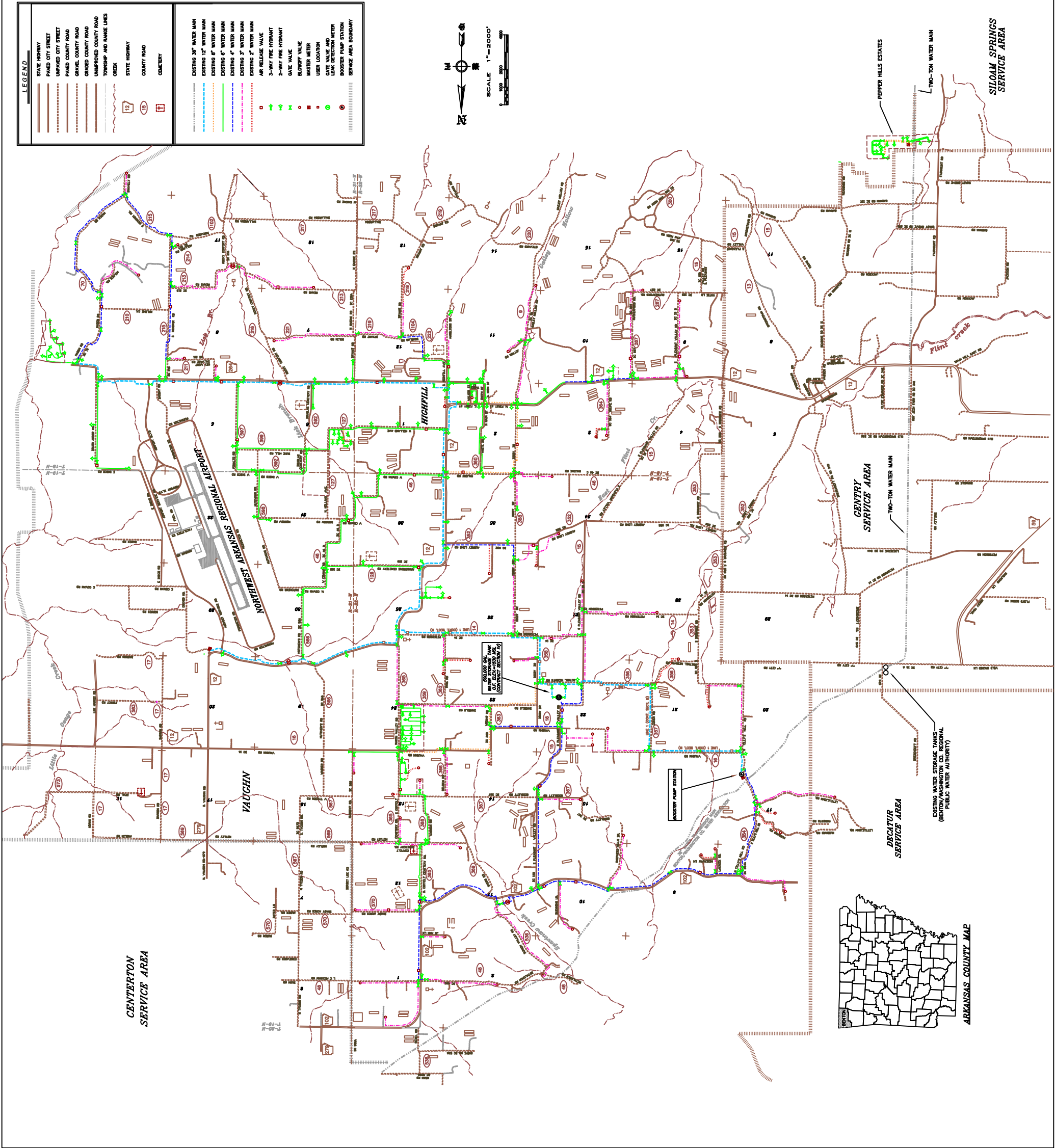
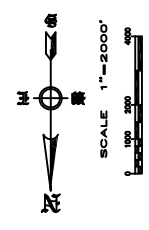

EXISTING WATER STORAGE TANKS
(BENTON/WASHINGTON CO. REGIONAL
PUBLIC WATER AUTHORITY)

BOOSTER PUMP STATION

REMOVED ALL
WATER STORAGE TANKS
(CONTRACT SECTION 10)

SILOAM SPRINGS
SERVICE AREA

CENTRY
SERVICE AREA

DECATUR
SERVICE AREA

CENTERTON
SERVICE AREA

VAUGHN

HIGHFILL

NORTHWEST ARKANSAS
REGIONAL AIRPORT

PEPPER HILLS ESTATES

TWO-TON WATER MAIN

PLUM Creek